

| STYLE | FREE DIA | LH | LENGTH | MAT'L (NOTE) | MATING PIN Ø REF | PLATING NOTE NO. | NUM LOUV | MAT'L THK | REF | PART NO. | |
|---------------|----------|--------|---------|--------------|------------------|------------------|----------|------------|-------|------------|------------------------|
| A | [.34] | [.043] | -- | 12 | 6.35[.250] | UNPL | 18 | 0.15[.006] | 03142 | 5-192038-0 | OBSOLETE ¹⁶ |
| A | [.34] | [.030] | -- | 12 | 6.35[.250] | 3-2 | 18 | 0.15[.006] | 03028 | 4-192038-9 | |
| A | [.34] | [.030] | -- | 12 | 6.35[.250] | 1-2 | 18 | 0.15[.006] | 03086 | 4-192038-8 | |
| A | [.34] | [.030] | -- | 12 | 6.35[.250] | UNPL | 18 | 0.15[.006] | 03074 | 4-192038-7 | OBSOLETE ¹⁶ |
| A | -- | -- | -- | 12 | 6.30[.248] | UNPL | 19 | 0.30[.012] | -- | 4-192038-6 | ¹⁵ |
| A | -- | -- | -- | 12 | 6.30[.248] | UNPL | 19 | 0.28[.011] | -- | 4-192038-5 | ¹⁵ |
| A | [.35] | [.034] | -- | 12 | 6.30[.248] | 3-2 | 19 | 0.25[.010] | 03025 | 4-192038-4 | ¹⁶ |
| A | [.35] | [.034] | -- | 12 | 6.30[.248] | 1-2 | 19 | 0.25[.010] | 03147 | 4-192038-3 | OBSOLETE ¹⁶ |
| A | [.35] | [.034] | -- | 12 | 6.30[.248] | UNPL | 19 | 0.25[.010] | 03111 | 4-192038-2 | OBSOLETE ¹⁶ |
| A | [.32] | [.038] | -- | 12 | 6.00[.236] | 4-2 | 17 | 0.20[.008] | 03137 | 4-192038-1 | |
| A | [.32] | [.038] | -- | 12 | 6.00[.236] | 3-2 | 17 | 0.20[.008] | 03023 | 4-192038-0 | |
| A | [.32] | [.038] | -- | 12 | 6.00[.236] | 1-2 | 17 | 0.20[.008] | 03065 | 3-192038-9 | ¹⁶ |
| A | [.32] | [.034] | -- | 12 | 6.00[.236] | UNPL | 17 | 0.20[.008] | 03061 | 3-192038-8 | OBSOLETE ¹⁶ |
| A | [.33] | [.034] | -- | 12 | 6.00[.236] | 3-2 | 17 | 0.15[.006] | 03022 | 3-192038-7 | |
| A | [.33] | [.034] | -- | 12 | 6.00[.236] | 1-2 | 17 | 0.15[.006] | 03113 | 3-192038-6 | ¹⁶ |
| A | [.33] | [.034] | -- | 12 | 6.00[.236] | UNPL | 17 | 0.15[.006] | 03021 | 3-192038-5 | OBSOLETE ¹⁶ |
| NOT AVAILABLE | | | | | | | | | | | |
| A | [.35] | [.020] | -- | 13 | 6.00[.236] | -- | 17 | 0.12[.005] | 03085 | 3-192038-3 | ¹⁵ |
| NOT AVAILABLE | | | | | | | | | | | |
| A | [.26] | [.034] | -- | 12 | 5.00[.197] | 3-2 | 15 | 0.20[.008] | 03019 | 3-192038-1 | ¹⁶ |
| A | [.26] | [.034] | -- | 12 | 5.00[.197] | 1-2 | 15 | 0.20[.008] | 03131 | 3-192038-0 | OBSOLETE ¹⁶ |
| A | [.26] | [.034] | -- | 12 | 5.00[.197] | UNPL | 15 | 0.20[.008] | 03130 | 2-192038-9 | |
| A | [.26] | [.031] | -- | 12 | 5.00[.197] | 3-2 | 15 | 0.15[.006] | 03018 | 2-192038-8 | |
| A | [.26] | [.031] | -- | 12 | 5.00[.197] | 1-2 | 15 | 0.15[.006] | 03064 | 2-192038-7 | ¹⁶ |
| A | [.26] | [.031] | -- | 12 | 5.00[.197] | 5 | 15 | 0.15[.006] | 03103 | 2-192038-6 | OBSOLETE ¹⁶ |
| A | [.26] | [.031] | -- | 12 | 5.00[.197] | UNPL | 15 | 0.15[.006] | 03060 | 2-192038-5 | OBSOLETE ¹⁶ |
| A | [.23] | [.034] | -- | 12 | 4.00[.157] | 3-2 | 14 | 0.20[.008] | 03013 | 2-192038-4 | |
| A | [.23] | [.030] | -- | 12 | 4.00[.157] | 3-2 | 14 | 0.15[.006] | 03012 | 2-192038-3 | ¹⁶ |
| A | [.21] | [.030] | -- | 12 | 3.50[.138] | 3-2 | 13 | 0.15[.006] | 03011 | 2-192038-2 | |
| A | [.21] | [.034] | -- | 12 | 3.17[.125] | 3-2 | 12 | 0.20[.008] | 03010 | 2-192038-1 | ¹⁶ |
| A | [.21] | [.034] | -- | 12 | 3.17[.125] | 1-2 | 12 | 0.10[.004] | 03132 | 2-192038-0 | OBSOLETE ¹⁶ |
| A | [.21] | [.034] | -- | 12 | 3.17[.125] | 5 | 12 | 0.10[.004] | 03133 | 1-192038-9 | ¹⁵ |
| A | [.21] | [.034] | -- | 12 | 3.17[.125] | UNPL | 12 | 0.10[.004] | 03134 | 1-192038-8 | |
| A | [.20] | [.030] | -- | 12 | 3.00[.118] | 3-2 | 11 | 0.15[.006] | 03009 | 1-192038-7 | |
| A | [.19] | [.030] | -- | 12 | 3.00[.118] | 3-2 | 10 | 0.15[.006] | 03008 | 1-192038-6 | |
| A | [.18] | [.030] | -- | 12 | 2.67[.105] | 3-2 | 9 | 0.15[.006] | 03007 | 1-192038-5 | |
| A | [.18] | [.030] | -- | 12 | 2.31[.091] | 3-2 | 8 | 0.15[.006] | 03006 | 1-192038-4 | ¹⁶ |
| A | [.15] | [.030] | -- | 12 | 2.03[.080] | 3-2 | 7 | 0.15[.006] | 03005 | 1-192038-3 | |
| A | [.15] | [.030] | -- | 12 | 1.70[.067] | 3-2 | 6 | 0.15[.006] | 03004 | 1-192038-2 | |
| C | -- | [.038] | NOTE 14 | 12 | -- | 3-2 | -- | 0.20[.008] | 03000 | 1-192038-1 | OBSOLETE ¹⁶ |
| C | -- | [.038] | NOTE 14 | 12 | -- | 1-2 | -- | 0.20[.008] | 03095 | 1-192038-0 | OBSOLETE ¹⁶ |
| C | -- | [.038] | NOTE 14 | 12 | -- | UNPL | -- | 0.20[.008] | 03077 | 192038-9 | |
| C | -- | [.034] | NOTE 14 | 12 | -- | 4-2 | -- | 0.15[.006] | 03123 | 192038-8 | |
| C | -- | [.034] | NOTE 14 | 12 | -- | 3-2 | -- | 0.15[.006] | 03053 | 192038-7 | OBSOLETE ¹⁶ |
| C | -- | [.034] | NOTE 14 | 12 | -- | 1-2 | -- | 0.15[.006] | 03104 | 192038-6 | |
| C | -- | [.034] | NOTE 14 | 12 | -- | UNPL | -- | 0.15[.006] | 03001 | 192038-5 | ¹⁶ |
| NOT AVAILABLE | | | | | | | | | | | |
| NOT AVAILABLE | | | | | | | | | | | |
| NOT AVAILABLE | | | | | | | | | | | |
| NOT AVAILABLE | | | | | | | | | | | |

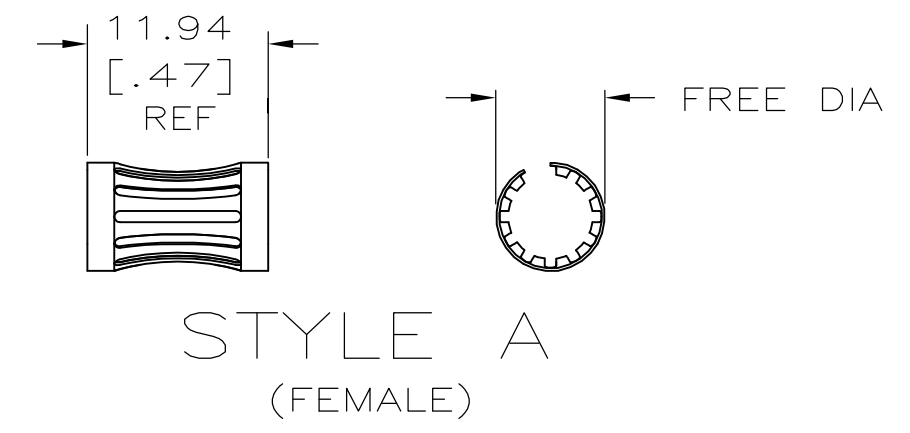
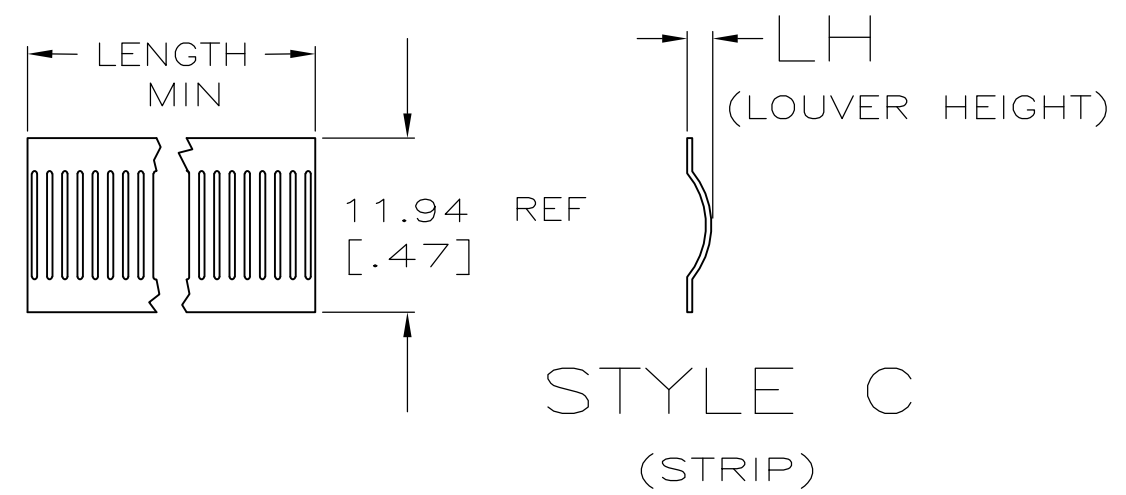

- 1 FINISH-SILVER PLATE 200µIN MIN THICK.
- 2 FINISH-NICKEL PLATE 40µIN MIN THICK.
- 3 FINISH-GOLD PLATE 10µIN MIN THICK.
- 4 FINISH-GOLD PLATE 50µIN MIN THICK.
- 5 FINISH-NICKEL PLATE 80µIN MIN THICK.
- 6 FINISH-TIN PLATE 300µIN MIN THICK.
- 7 NOT USED.
- 8 NOT USED.
- 9 NOT USED.
- 10 NOT USED.
- 11 PLATING NOTE ARE TO BE INTERPRETED AS FOLLOWS, 6-8 AS 6 OVER 8.
- 12 MATERIAL-CDA172, BeCu.
- 13 MATERIAL-STAINLESS STEEL.
- 14 PRODUCT IS SOLD BY THE FOOT.
- ¹⁵ OBSOLETE PART NUMBER.
- ¹⁶ OBSOLETE PARTS: OBSOLETE CIS STREAMLINING PER D.RENAUD/D.SINISI

| | | | | | | | | | | | | | | | | | | | | | | |
|--|-----------|-------------|-----------|---------------|-------------------------------|-------|---|---|-------|---|-----------|-------|---|-------------|-------|---|---|--------|---|---|------|--|
| THIS DRAWING IS A CONTROLLED DOCUMENT. | | DWN | RA JAYNE | 08-13-91 | STE TE Connectivity | | | | | | | | | | | | | | | | | |
| DIMENSIONS: MM [INCHES] | | CHK | RA JAYNE | 08-13-91 | | | | | | | | | | | | | | | | | | |
| TOLERANCES UNLESS OTHERWISE SPECIFIED: | | APVD | RA JAYNE | 08-13-91 | | | | | | | | | | | | | | | | | | |
| <table border="1"> <tr><td>0 PLC</td><td>±</td><td>-</td></tr> <tr><td>1 PLC</td><td>±</td><td>-</td></tr> <tr><td>2 PLC</td><td>±</td><td>0.5 [.02]</td></tr> <tr><td>3 PLC</td><td>±</td><td>0.25 [.010]</td></tr> <tr><td>4 PLC</td><td>±</td><td>-</td></tr> <tr><td>ANGLES</td><td>±</td><td>-</td></tr> </table> | | 0 PLC | ± | - | | 1 PLC | ± | - | 2 PLC | ± | 0.5 [.02] | 3 PLC | ± | 0.25 [.010] | 4 PLC | ± | - | ANGLES | ± | - | NAME | |
| 0 PLC | ± | - | | | | | | | | | | | | | | | | | | | | |
| 1 PLC | ± | - | | | | | | | | | | | | | | | | | | | | |
| 2 PLC | ± | 0.5 [.02] | | | | | | | | | | | | | | | | | | | | |
| 3 PLC | ± | 0.25 [.010] | | | | | | | | | | | | | | | | | | | | |
| 4 PLC | ± | - | | | | | | | | | | | | | | | | | | | | |
| ANGLES | ± | - | | | | | | | | | | | | | | | | | | | | |
| MATERIAL | SEE TABLE | FINISH | SEE TABLE | WEIGHT | - | | | | | | | | | | | | | | | | | |
| CUSTOMER DRAWING | | SCALE | NTS | SHEET | 1 OF 2 | | | | | | | | | | | | | | | | | |
| REV | | J | | RESTRICTED TO | | | | | | | | | | | | | | | | | | |

THIS DRAWING IS UNPUBLISHED. RELEASED FOR PUBLICATION
 © COPYRIGHT - By - ALL RIGHTS RESERVED.

| LOC | DIST | REVISIONS | | | | | |
|-----|------|-----------|-----|-------------|------|-----|------|
| FT | 0 | P | LTR | DESCRIPTION | DATE | DWN | APVD |
| | | - | | SEE SHEET 1 | - | - | - |

| STYLE | FREE DIA | LH | LENGTH | MAT'L (NOTE) | MATING PIN Ø REF | PLATING NUM NOTE NO. LOUV | MAT'L THK | REF | PART NUMBER |
|-------|----------|--------|--------|--------------|------------------|---------------------------|-----------|------------|------------------|
| A | [1.00] | [.034] | -- | 12 | 17.98[.708] | 1-2 | 53 | 0.20[.008] | 03114 9-192038-9 |
| A | [.90] | [.038] | -- | 12 | 16.00[.630] | 1-2 | 46 | 0.20[.008] | 03107 9-192038-8 |
| A | [.90] | [.038] | -- | 12 | 16.00[.630] | UNPL | 46 | 0.20[.008] | 03146 9-192038-7 |
| A | [.80] | [.034] | -- | 12 | 14.00[.551] | 3-2 | 42 | 0.20[.008] | -- 9-192038-6 |
| A | [.62] | [.034] | -- | 12 | 12.70[.500] | 1-2 | 38 | 0.20[.008] | 03097 9-192038-5 |
| A | [.62] | [.034] | -- | 12 | 12.70[.500] | 6 | 38 | 0.20[.008] | 03090 9-192038-4 |
| A | [.62] | [.034] | -- | 12 | 12.70[.500] | UNPL | 38 | 0.20[.008] | 03099 9-192038-3 |
| A | -- | -- | -- | 12 | 12.70[.500] | 3-2 | 37 | 0.20[.008] | 03047 9-192038-2 |
| A | -- | -- | -- | 12 | 12.70[.500] | 1-2 | 37 | 0.20[.008] | 03068 9-192038-1 |
| A | -- | -- | -- | 12 | 12.70[.500] | UNPL | -- | 0.20[.008] | 03059 9-192038-0 |
| A | [.62] | [.030] | -- | 12 | 12.70[.500] | 1-2 | 36 | 0.15[.006] | 03117 8-192038-9 |
| A | [.62] | [.020] | -- | 13 | 12.70[.500] | UNPL | 37 | 0.12[.005] | 03092 8-192038-8 |
| A | [.62] | [.034] | -- | 12 | 11.99[.472] | 3-2 | 36 | 0.20[.008] | -- 8-192038-7 |
| A | [.62] | [.034] | -- | 12 | 11.99[.472] | 1-2 | 36 | 0.20[.008] | 03108 8-192038-6 |
| A | [.62] | [.034] | -- | 12 | 11.99[.472] | UNPL | 36 | 0.20[.008] | 03135 8-192038-5 |
| A | [.60] | [.034] | -- | 12 | 11.10[.437] | 3-2 | 34 | 0.20[.008] | 03045 8-192038-4 |
| A | [.60] | [.034] | -- | 12 | 11.10[.437] | 1-2 | 34 | 0.20[.008] | 03106 8-192038-3 |
| A | [.60] | [.034] | -- | 12 | 11.10[.437] | UNPL | 34 | 0.20[.008] | 03081 8-192038-2 |
| A | [.58] | [.034] | -- | 12 | 11.10[.437] | 1-2 | 32 | 0.20[.008] | 03102 8-192038-1 |
| A | [.58] | [.034] | -- | 12 | 11.10[.437] | UNPL | 32 | 0.20[.008] | 03109 8-192038-0 |
| A | [.58] | [.020] | -- | 13 | 11.10[.437] | UNPL | 32 | 0.12[.005] | 03118 7-192038-9 |
| A | [.60] | [.034] | -- | 12 | 10.79[.425] | 4-2 | 34 | 0.20[.008] | 03105 7-192038-8 |
| A | [.55] | [.038] | -- | 12 | 10.00[.394] | 1-2 | 30 | 0.20[.008] | 03069 7-192038-7 |
| A | [.55] | [.038] | -- | 12 | 10.00[.394] | UNPL | 30 | 0.20[.008] | 03072 7-192038-6 |
| A | -- | -- | -- | 12 | 10.00[.394] | 3-2 | 30 | 0.15[.006] | 03044 7-192038-5 |
| A | [.50] | [.034] | -- | 12 | 9.52[.375] | 3-2 | 27 | 0.20[.008] | 03093 7-192038-4 |
| A | [.50] | [.034] | -- | 12 | 9.52[.375] | 1-2 | 27 | 0.20[.008] | 03089 7-192038-3 |
| A | [.50] | [.034] | -- | 12 | 8.89[.350] | UNPL | 28 | 0.20[.008] | 03112 7-192038-2 |
| A | -- | -- | -- | 12 | 8.00[.315] | 3-2 | -- | 0.12[.005] | 03043 7-192038-1 |
| A | -- | -- | -- | 12 | 8.00[.315] | 3-2 | -- | 0.20[.008] | 03040 7-192038-0 |
| A | -- | -- | -- | 12 | 8.00[.315] | 1-2 | -- | 0.20[.008] | 03098 6-192038-9 |
| A | -- | -- | -- | 12 | 8.00[.315] | 1-2 | -- | 0.20[.008] | 03070 6-192038-8 |
| A | -- | -- | -- | 12 | 8.00[.315] | UNPL | -- | 0.20[.008] | 03039 6-192038-7 |
| A | [.42] | [.034] | -- | 12 | 8.00[.315] | 3-2 | 22 | 0.20[.008] | 03141 6-192038-6 |
| A | [.42] | [.034] | -- | 12 | 8.00[.315] | 1-2 | 22 | 0.20[.008] | 03101 6-192038-5 |
| A | [.42] | [.034] | -- | 12 | 8.00[.315] | UNPL | 22 | 0.20[.008] | 03100 6-192038-4 |
| A | -- | -- | -- | 12 | 6.60[.260] | 3-2 | -- | 0.15[.006] | 03038 6-192038-3 |
| A | -- | -- | -- | 12 | 6.35[.250] | UNPL | -- | 0.15[.006] | 03037 6-192038-2 |
| A | [.32] | [.036] | -- | 12 | 7.11[.280] | 3-2 | 20 | 0.20[.008] | 03033 6-192038-1 |
| A | [.32] | [.036] | -- | 12 | 7.11[.280] | 1-2 | 20 | 0.20[.008] | 03063 6-192038-0 |
| A | [.32] | [.036] | -- | 12 | 7.11[.280] | UNPL | 20 | 0.20[.008] | 03076 5-192038-9 |
| A | [.32] | [.020] | -- | 13 | 7.11[.280] | UNPL | 20 | 0.20[.008] | 03083 5-192038-8 |
| A | -- | -- | -- | 12 | 6.60[.260] | 3-2 | 19 | 0.20[.008] | 03032 5-192038-7 |
| A | -- | -- | -- | 12 | 6.35[.250] | UNPL | 18 | 0.20[.008] | 03031 5-192038-6 |
| A | [.35] | [.034] | -- | 12 | 6.35[.250] | UNPL | 19 | 0.20[.008] | 03136 5-192038-5 |
| A | [.31] | [.034] | -- | 12 | 6.35[.250] | 3-2 | 18 | 0.20[.008] | 03029 5-192038-4 |
| A | [.31] | [.034] | -- | 12 | 6.35[.250] | 1-2 | 18 | 0.20[.008] | 03075 5-192038-3 |
| A | [.31] | [.034] | -- | 12 | 6.35[.250] | UNPL | 18 | 0.20[.008] | 03062 5-192038-2 |
| A | [.35] | [.043] | -- | 12 | 6.35[.250] | 1-2 | 18 | 0.15[.006] | 03143 5-192038-1 |



OBSOLETE



OBSOLETE



OBSOLETE



OBSOLETE



OBSOLETE

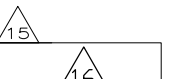

OBSOLETE

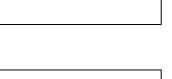

OBSOLETE



OBSOLETE



OBSOLETE



OBSOLETE



OBSOLETE

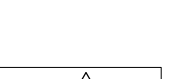

OBSOLETE



OBSOLETE



OBSOLETE



OBSOLETE

D

C

B

A

D

C

B

A

192038

| | | | | | |
|--|--|--|--|---|--|
| THIS DRAWING IS A CONTROLLED DOCUMENT. | | DWN RA JAYNE 08-13-91 | | TE Connectivity | |
| | | CHK RA JAYNE 08-13-91 | | NAME CONTACT BAND,FEMALE | |
| DIMENSIONS: MM [INCHES] | | TOLERANCES UNLESS OTHERWISE SPECIFIED: | | PRODUCT SPEC | |
| | | 0 PLC ± - | | APPLICATION SPEC | |
| | | 1 PLC ± - | | - | |
| | | 2 PLC ± 0.5 [.02] | | - | |
| | | 3 PLC ± 0.25 [.010] | | - | |
| MATERIAL SEE TABLE | | FINISH SEE TABLE | | WEIGHT - | |
| | | | | SIZE A2 CAGE CODE 00779 DRAWING NO G-192038 RESTRICTED TO - | |
| | | | | CUSTOMER DRAWING SCALE NTS SHEET 2 OF 2 REV J | |